

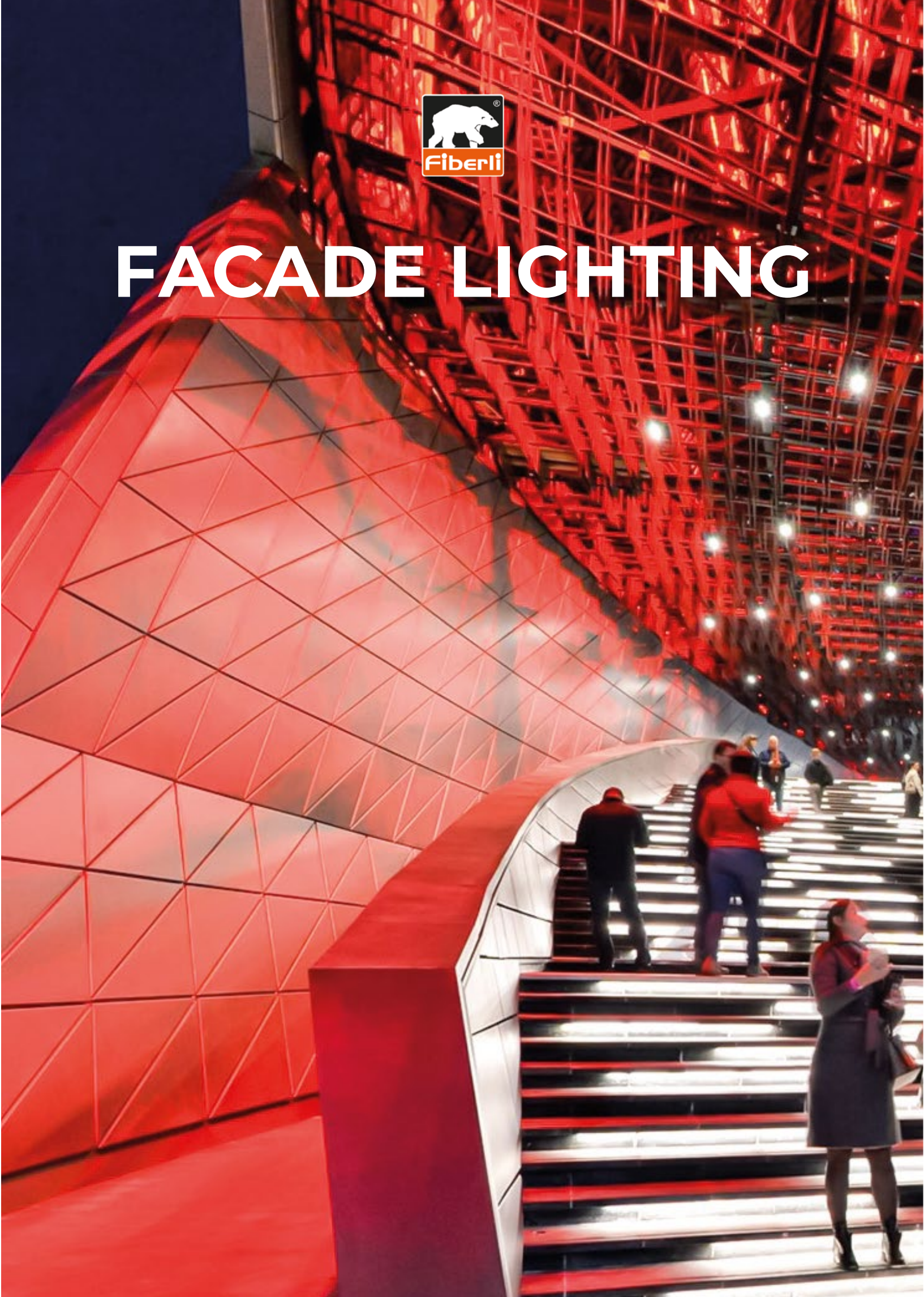

# FACADE LIGHTING





2024  
FACADE LIGHTING



## INTRODUCTION

In the radiant world of architectural lighting, Fiberli stands as a beacon of innovation and excellence. PSL Elektronik, our esteemed parent company, pioneered fiber optic lighting systems in Turkey, marking a historic milestone in 1991. Evolving from a focus on professional sound and light systems, Fiberli emerged in 1997, seamlessly blending fiber optic technology with decorative lighting aesthetics under its iconic brand.

Anticipating the pivotal role of LED lighting technologies in shaping urban identities and aesthetics, Fiberli made a strategic decision in the early 2000s to specialize in landscape and architectural lighting. Over the years, the company's commitment to values such as locality, innovation, high quality, customer-centricity, and sustainability has propelled Fiberli to become a leader in the global lighting industry.

Fiberli's production philosophy, centered around innovation, has yielded award-winning research and development activities. Notably, the company has ventured into optical-based security technologies for the defense industry, showcasing its prowess beyond the realm of lighting. Last year, Fiberli proudly became the first and only architectural lighting company to be honored with the prestigious TURQUALITY Global Brand Program by the Ministry of Economy, recognizing its status as one of the most competitive firms in the sector.

As we step into 2023, Fiberli stands tall with a 23,000-square-meter manufacturing facility in Antalya Organized Industrial Zone, a dedicated team of nearly 300 professionals, and a legacy of thousands of projects spanning the globe. Exporting lighting fixtures and technologies to 70 countries, our commitment to excellence remains unwavering. Fiberli's pervasive reputation is built on providing turnkey facade lighting systems, including control systems, and impeccable installation and maintenance services for airports, skyscrapers, bridges & shopping malls.

At the heart of our continued success lies our strategically positioned sales and service teams worldwide, our ability to tailor solutions to the unique needs of businesses, and the expertise of our designers and engineers. We extend our heartfelt gratitude to all our business partners who have chosen and supported us on this remarkable journey.

*Fiberli, A better way to see!*

## STORY BEHIND THE POLAR BEAR

### *Harnessing Nature's Brilliance for Sustainable Lighting*

*In the vast icy landscapes where polar bears reign supreme, the seemingly endless stretches of white are not just a shield against the cold, but a testament to the ingenious workings of nature. It's a common misconception that the thick white fur of polar bears solely protects them from the harsh Arctic temperatures. Contrary to appearances, the bears' skin is closer to black in color. What appears to be a simple coat of fur is, in fact, a marvel of natural engineering.*

*Each white hair in the polar bear's fur possesses fiber-optic properties, acting as a conduit for sunlight. Instead of merely providing insulation, these hairs channel sunlight directly to the bear's black-pigmented skin, where it is converted into heat. This incredible mechanism allows polar bears to maximize the efficiency of the sun's energy, adapting seamlessly to their environment. In much the same way, Fiberli draws inspiration from this remarkable synergy of nature. Our logo, symbolized by the polar bear, encapsulates our commitment to energy efficiency and the perfect harmony of technology and the environment. The polar bear's ability to harness sunlight aligns with Fiberli's ethos of utilizing cutting-edge technology to create lighting solutions that not only illuminate spaces with brilliance but also do so in the most sustainable manner.*



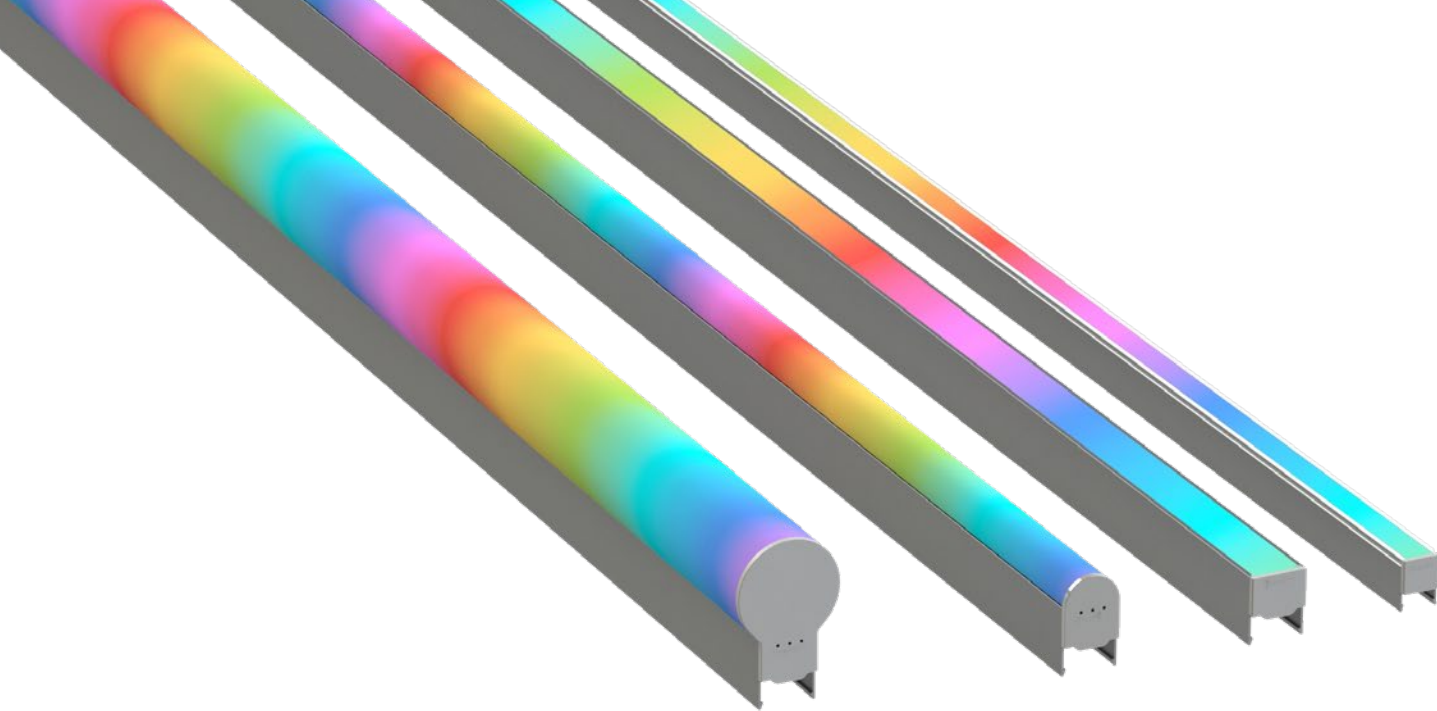

Clever LED Line

# C-LINE

With its outstanding slim design, Fiberli C-Line is produced with 30% less material compared to its previous versions, aligning with the sustainability goals of our contemporary world. The C-Line, crafted based on principles of circularity, sources all its raw materials from local suppliers, emphasizing a philosophy deeply rooted in sustainability and local circular economies without compromising on technology.

C-Line’s Balanced High Voltage feature eliminates the need for electrical feedback cables in the field. This not only results in material savings but also accelerates project implementation by reducing assembly times. This innovative approach underscores the product’s commitment to resource efficiency and timely project execution.

Finally, with its True Color technology, C-Line ensures the homogeneous and vibrant display of all colors by utilizing all energy specifically for each color while it is illuminated, rather than dividing the consumed energy across different colors. This innovative approach enhances the overall visual experience, emphasizing the product’s commitment to vivid and consistent color representation.

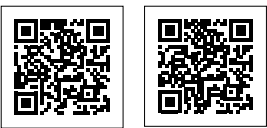
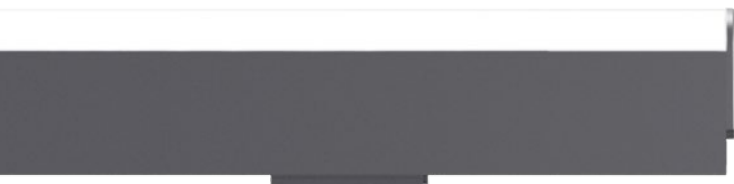





Balanced High Voltage



True Color



Lock & Light



Slim Design

KEY FEATURES

- Balanced High Voltage Technology
- True Color
- Slim Design
- Lock & Light System

Clever Led Line

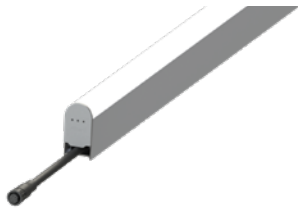

C-LINE

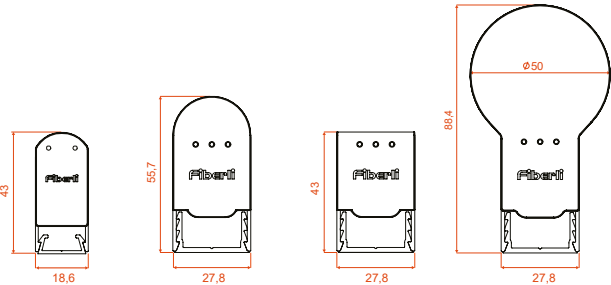

Product Overview

Product Name	Input Voltage	Control System	Power	Pixel Count	Luminous Flux	Length
C-LINE-28-MONO	48V DC	On-Off	7 W/m	-	510 lm/m	200 mm 600 mm 1200 mm
C-LINE-28-RGB		DMX		5 px/m	313 lm/m	
C-LINE-28-RGB		9 W/m	10 px/m	330 lm/m		
C-LINE-28-RGBW			5 px/m	480 lm/m		
C-LINE-28-RGBW			10 px/m	507 lm/m		

Product Name	Input Voltage	Control System	Power	Pixel Count	Luminous Flux	Length
C-LINE-18-MONO	48V DC	On-Off	7 W/m	-	455 lm/m	200 mm 600 mm 1200 mm
C-LINE-18-RGB		DMX		5 px/m	192 lm/m	
C-LINE-18-RGB		9 W/m	10 px/m	203 lm/m		
C-LINE-18-RGBW			5 px/m	297 lm/m		
C-LINE-18-RGBW			10 px/m	313 lm/m		

\*Luminous flux values represent maximum values.  
\*Monochrome product measurements is 6500K, DMX product measurements are All-On values.

General Information

Color Temperature	1800K   3000K   4000K   6500K   RGB   RGBW
Optics	Clear   Diffuse
Color Rendering Index (CRI)	Ra>80
Pixel Pitch (DMX)	10cm   20cm
IP & IK Rating	IP 66, IK 08
Housing Material	Anodized aluminum extruded profile, polycarbonate cap, PCV side cover

Available Options

Upper Cover

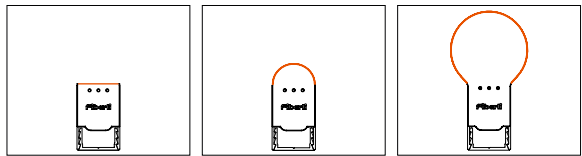

Flat Cover      Oval Cover      Convex Cover  
\* Flat & Convex options only available for C-Line 28

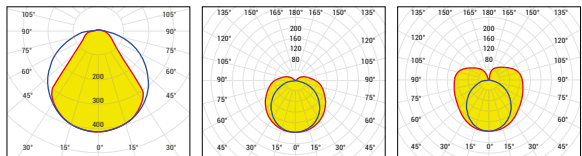

Flat Cover      Oval Cover      Convex Cover

Finishing



Anodized grey      RAL 7012      RAL 9005

Mounting

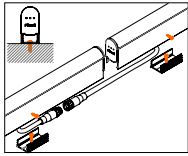

Screw







Megapol - İzmir



Orbi Twin Towers - Georgia





# Wall Grazer WLT

Equipped with different lens options, WLT provides lighting designers, architects and consultants with precise beam control that would elevate architectural spaces to new heights, allowing for the creation of dynamic visual experiences tailored to perfection. WLT can graze up to 12 meters while homogenously distributing the light along the pathway. With the active shield embedded in its structure, WLT wallwashers provide you with an experience of perfect balance between stunning illumination and gentle ambiance, eliminating glare and enhancing the overall aesthetic appeal of your environment based on visual comfort.

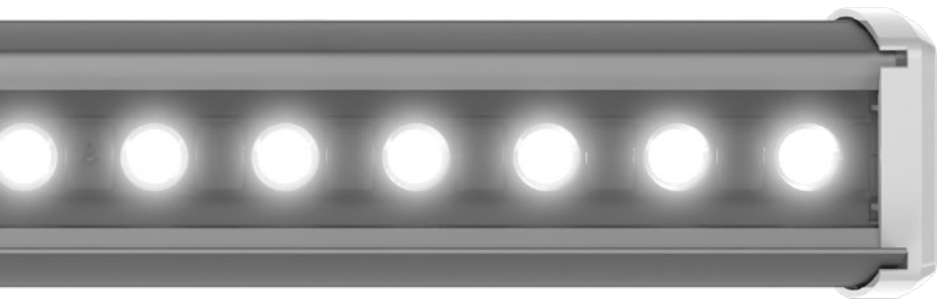

## KEY FEATURES

- Active shield
- Extra durable tempered glass
- Wide choice of lenses
- Homogeneous graze effect up to 12 meters\*



\*May depends on architectural texture and project characteristics.



## Wall Grazer

## WLT

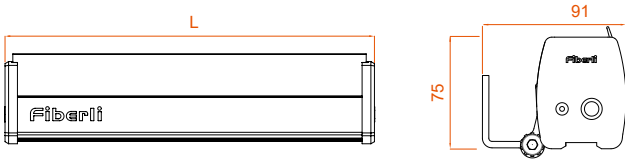

## Product Overview

Product Name	Input Voltage	Control System	Power	Luminous Flux	Length (L)	Weight
WLT112-MONO	220-240V AC	On-Off	20 W	2.424 lm	310 mm	1,2 kg
WLT224-MONO			35 W	4.335 lm	610 mm	2,0 kg
WLT336-MONO			50 W	6.322 lm	905 mm	2,7 kg
WLT448-MONO			65 W	8.023 lm	1215 mm	3,4 kg
WLT112-RGBW		DMX	14 W	1.120 lm	310 mm	1,2 kg
WLT224-RGBW			28 W	2.240 lm	610 mm	2,0 kg
WLT336-RGBW			42 W	3.360 lm	905 mm	2,7 kg
WLT448-RGBW			56 W	4.183 lm	1215 mm	3,4 kg

\*Luminous flux values represent maximum values.  
\*Monochrome product measurements is 6500K, DMX product measurements are All-On values.

## General Information

Color Temperature	1800K   2700K   3000K   4000K   6500K   RGBW
Optics	10°   10°x45°   10°x60°   25°x45   25°   60°   90°
Efficiency (lm/W)	up to 125 lm/W (@6500K)
Color Rendering Index (CRI)	Ra>80
IP & IK Rating	IP 66, IK08, IK 10
Housing Material	Anodized aluminum extruded profile, tempered glass, PVC side covers

## Available Options

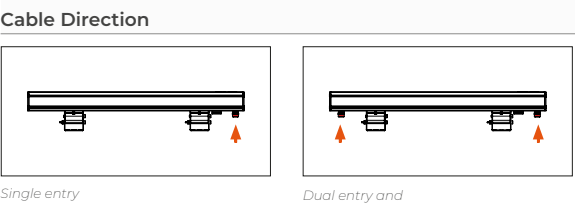
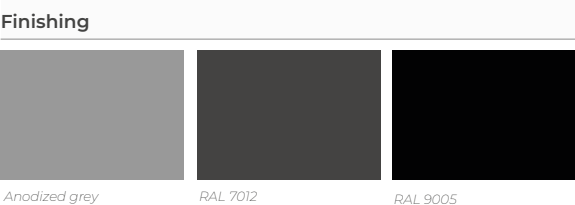
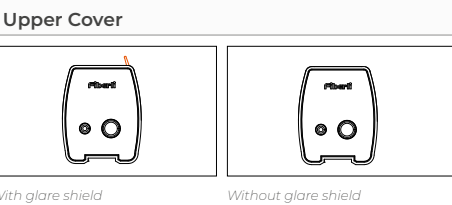
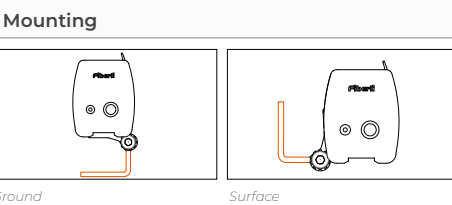







# Dual Output Wall Grazer WLTC

Descended from WLT family, WLTC's bilateral output achieves an efficient and effective illumination of walls, pillars and architectural details. Its versatility allows for creative freedom in lighting design, ensuring that your facade not only looks exceptional but feels inviting and well-lit from every angle. The bilateral output of a wallwasher, emitting light both upward and downward, is a design strategy that maximizes the impact of lighting while using fewer fixtures. This approach offers several advantages, making it a highly efficient and effective choice for various applications.



## KEY FEATURES

- Extra durable tempered glass
- Wide choice of lenses
- Homogeneous graze effect up to 12 meters\*



\*May depends on architectural texture and project characteristics.



## Dual Output Wall Grazer

WLTC

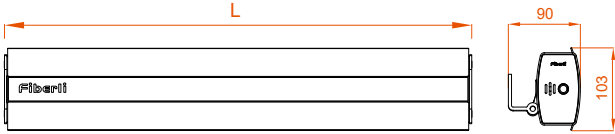

## Product Overview

Product Name	Input Voltage	Control System	Power	Luminous Flux	Length (L)	Weight
WLTC006	220-240V AC	On-Off	8 W	800 lm	110 mm	0,6 kg
WLTC012			15 W	1.650 lm	183 mm	0,9 kg
WLTC124			30 W	3.300 lm	330 mm	1,6 kg
WLTC248			55 W	6.050 lm	625 mm	2,7 kg
WLTC372			75 W	8.250 lm	920 mm	3,8 kg
WLTC496			100 W	11.000 lm	1215 mm	4,9 kg

## General Information

Color Temperature	1800K   2700K   3000K   4000K   6500K
Optics	10°   10°x45°   10°x60°   25°x45   25°   60°   90°
Efficacy (lm/W)	up to 110 lm/W (@6500K)
Color Rendering Index (CRI)	Ra>80
IP & IK Rating	IP 66, IK 07, IK 10
Housing Material	Anodized aluminum extruded profile, tempered glass, PVC/Chrome side covers

## Available Options

### Mounting

Surface

### Upper Cover

With glare shield

Without glare shield

### Finishing

Anodized grey

RAL 7012

RAL 9005

### Cable Direction

Single entry

Dual entry and exit









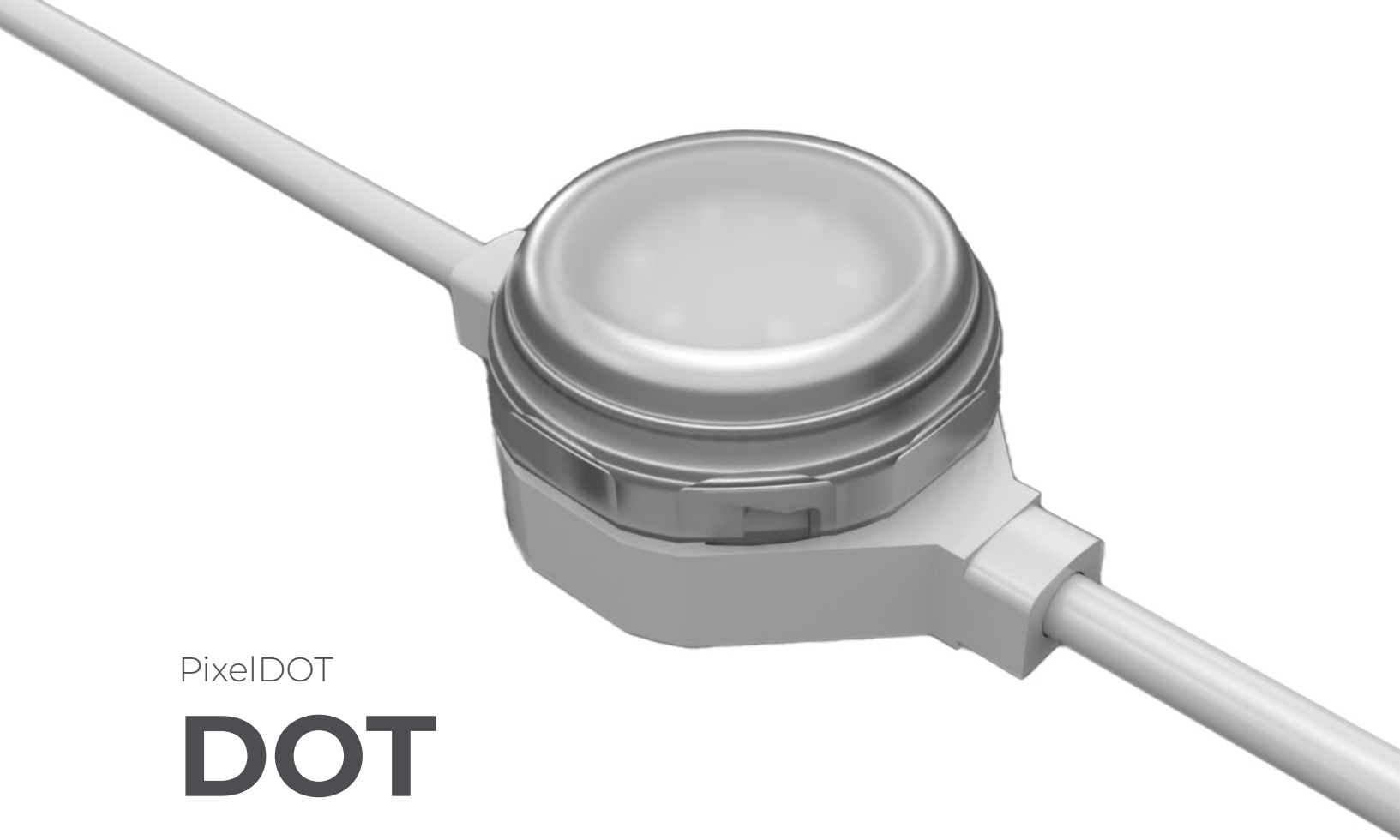

PixelDOT

# DOT DIAMOND

Reflect your own style

Crafted with ultralight materials, Dot Diamond eliminates concerns of additional static load on the facade, ensuring a harmonious blend of style and structural integrity. Our easy setup system (ESS) redefines efficiency by cutting down installation times to guarantee timely project implementation and smooth maintenance. What truly sets Dot Diamond apart is its individual control of each dot on the string, enabling sophisticated pixel mapping and, consequently, achieving advanced display quality.



## KEY FEATURES

- Individually controllable dots
- New gen chip RGBW
- Easy Setup System (ESS)
- Up to 50 dots per string
- Transparent or diffused cover options
- Ultra lightweight 70gr



## Pixel Dot



## Product Overview

Product Name	Input Voltage	Control System	Power	Luminous Flux	Dimensions (LxHxD)	Weight
DOT DIAMOND-RGBW	24V DC	DMX	2 W	117 lm	80x50X30,2 mm	0,07 kg

\*Luminous flux values represent maximum values.  
\*Monochrome product measurements is 6500K, DMX product measurements are All-On values.

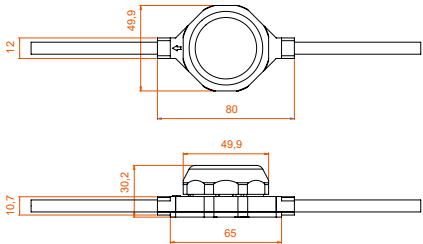

## General Information

Color Temperature	RGBW
Optics	Clear   Diffuse
Color Rendering Index (CRI)	Ra>80
IP & IK Rating	IP 66, IK08
Housing Material	PVC Injection Body, Polycarbonate Cover

## Available Options

### Mounting

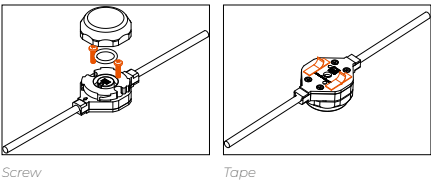

### Finishing



### Upper Cover

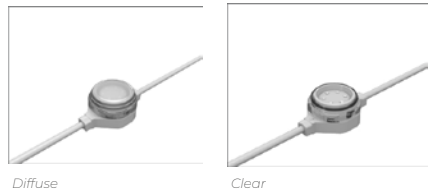





Alparslan Türkeş Bridge Interchange - Manisa



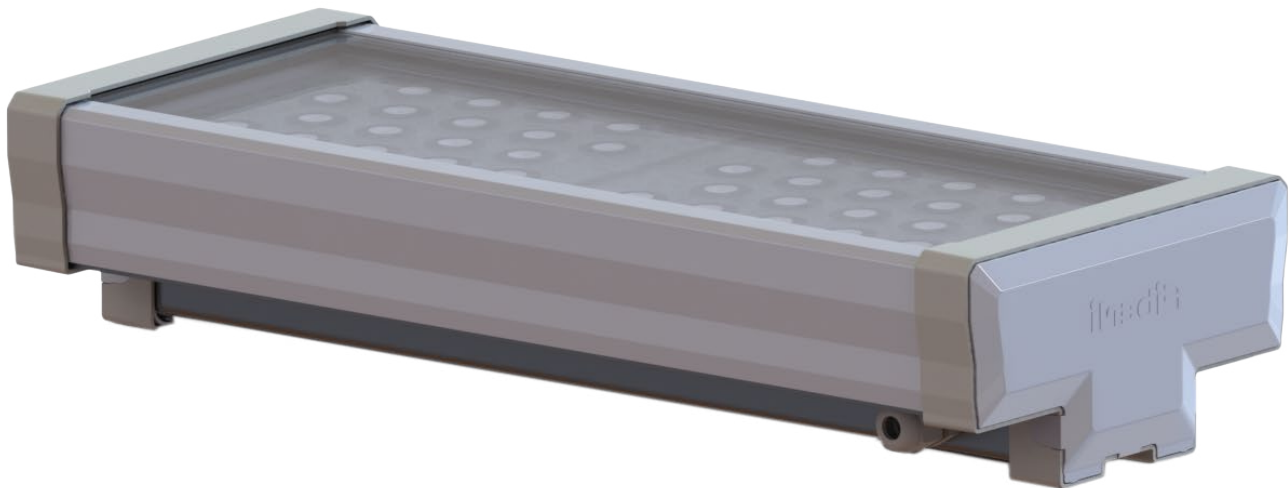

Wall Washer

# WS

WS is a testament to innovation, where minimalism meets maximum performance. The sleek and streamlined NanoFit Design not only adds a touch of modern sophistication to any space but also houses an unparalleled cooling capacity, ensuring optimal functionality even at its peak power. In scenarios where facades present limited space for large fixtures, WS emerges as the ideal choice. Its remarkable capability to contain immense power within a minimalist housing makes it a game-changer for architects and lighting designers facing spatial constraints.



KEY FEATURES

- NanoFit design is a game-changer for illuminating limited facade areas
- It provides high illumination with power options of up to 120W.
- Suitable for a diverse range of optical options in both grazing and washing applications.



Wall Washer

WS

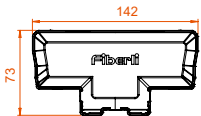
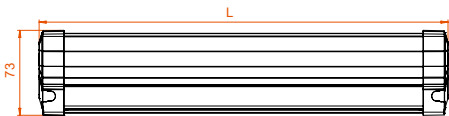

Product Overview

Product Name	Input Voltage	Control System	Power	Luminous Flux	Length (L)	Weight
WS118-MONO	220-240V AC	On-Off	20 W	3.072 lm	206 mm	1,8 kg
WS236-MONO			40 W	6.080 lm	351 mm	2,7 kg
WS354-MONO			60 W	9.250 lm	497 mm	3,6 kg
WS472-MONO			100 W	15.247 lm	643 mm	4,7 kg
WS118-RGB		DMX	20 W	1.140 lm	206 mm	1,8 kg
WS236-RGB			40 W	2.280 lm	351 mm	2,7 kg
WS354-RGB			60 W	3.420 lm	497 mm	3,6 kg
WS472-RGB			80 W	4.560 lm	643 mm	4,7 kg
WS116-RGBW			30 W	2.010 lm	206 mm	1,8 kg
WS232-RGBW			60 W	4.020 lm	351 mm	2,7 kg
WS348-RGBW			90 W	6.030 lm	497 mm	3,6 kg
WS464-RGBW			120 W	8.111 lm	643 mm	4,7 kg

\*Luminous flux values represent maximum values.  
\*Monochrome product measurements is 6500K, DMX product measurements are All-On values.

General Information

Color Temperature	1800K   2700K   3000K   4000K   6500K   RGB   RGBW
Optics	10°   25°   60°   90°
Efficiency (lm/W)	up to 152 lm/W (@6500K)
Color Rendering Index (CRI)	Ra>80
IP & IK Rating	IP 66, IK 07, IK 10
Housing Material	Anodized aluminum extruded profile, Clear polycarbonate cover, PVC side covers

Available Options

Mounting

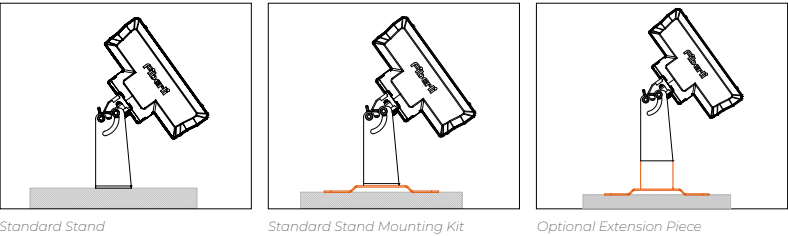

Finishing



www.fiberli.com















Patara Ancient City - Antalya

# Fiberli Features



**Balanced High Voltage:** C-Line's Balanced High Voltage feature eliminates the need for electrical feedback cables in the field.



**True Color:** By controlling the energy for each color, a homogeneous and vibrant appearance is achieved throughout the entire project.



**Lock & Light:** Thanks to feedback-free technology, it can be operated simply by plugging in the sockets without requiring any feedback.



**Slim Design:** As thin as a pencil sharpener on your desk, and additionally, produced with 30% less material.



**Active Shield:** It prevents unwanted glares with its special shield design.



**Anti Glare:** It provides homogeneous and balanced illumination by preventing unwanted glares.



**High Graze:** High-graze effect that highlights textures up to 12 meters.



**Dual Output:** Dual-directional lighting experience in a single fixture.



**Precise Beam:** Precise light angles are obtained through the right lens and manufacturing technology.



**Ultra Lightweight:** It does not impact the statics of the applied area, thanks to its ultra-light design.



**Easy Setup System:** Quick application thanks to easy installation.



**NanoFit Design:** With its stylish and minimalistic design, it seamlessly blends into the applied areas.



**High Power:** Highly efficient output power of up to 120 watts.



**Extensive Optical Range:** Optical range options that cater to both specific and general lighting needs.



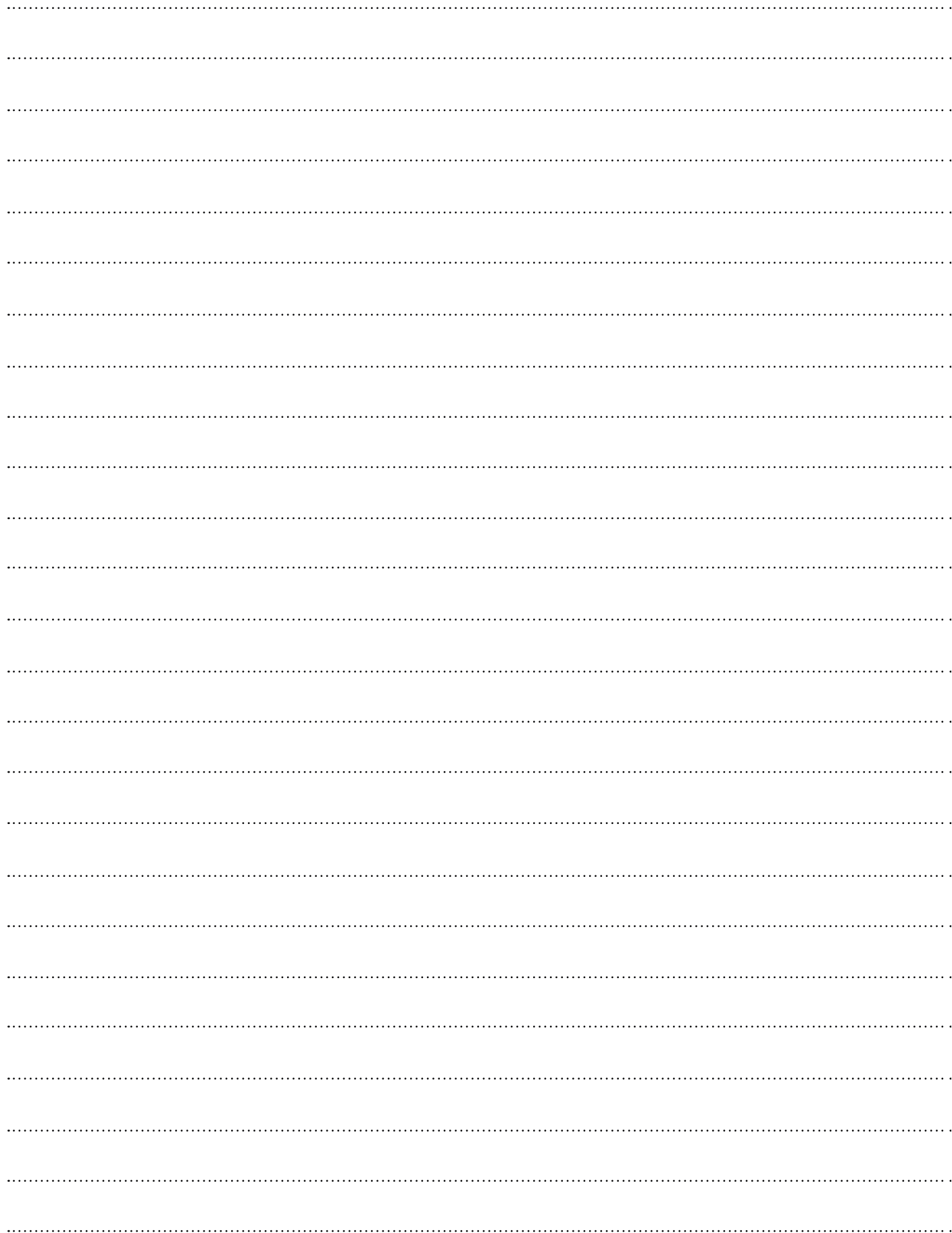





## PSL ELEKTRONİK SAN. ve TİC. A.Ş.

Headquarter - Factory: Organize Sanayi Bölgesi 3. Etap 25. Cad. No: 30  
Döşemealtı / ANTALYA  
Tel: +90(242) 228 81 50 (Pbx) Fax: +90(242) 228 16 18

İstanbul Office: Maslak Mh. Meydan Sk. No:3 Veko Giz Plaza Ofis No:23-24  
Sarıyer / İstanbul  
Tel: +90 212 220 05 06 (Pbx) Fax: +90 212 320 28 87

Ankara Office: Kızılırmak Mh. Ufuk Üniversitesi Cad. 11/B Arma Kule Kat:6  
D:7 Çankaya / Ankara  
Tel: +90 (312) 666 53 55

**[www.fiberli.com](http://www.fiberli.com)**